

Unterteil von Innen
Base inside

Oberteil von Aussen
Upper part outside

Oberteil von Innen
Upper part inside

ISO (1 : 1)

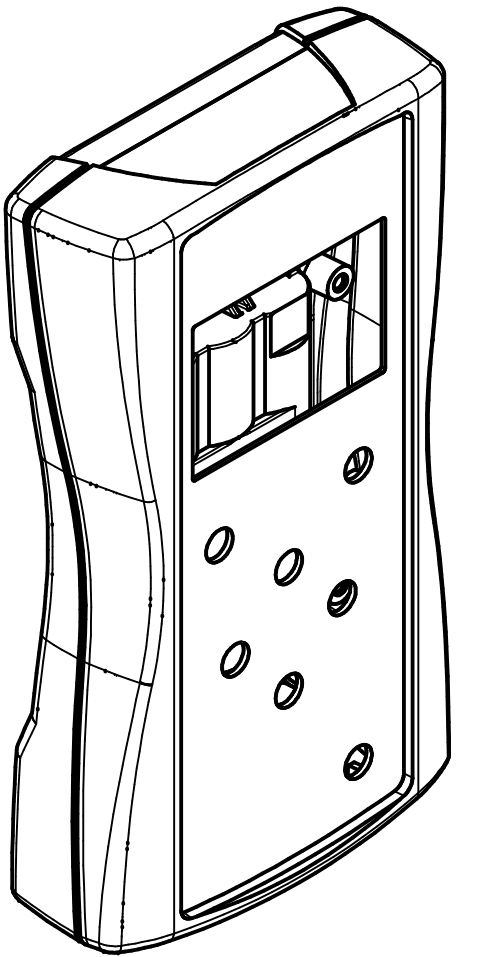

Diese 2 Flächen absenken
Please mill down these 2 Planes

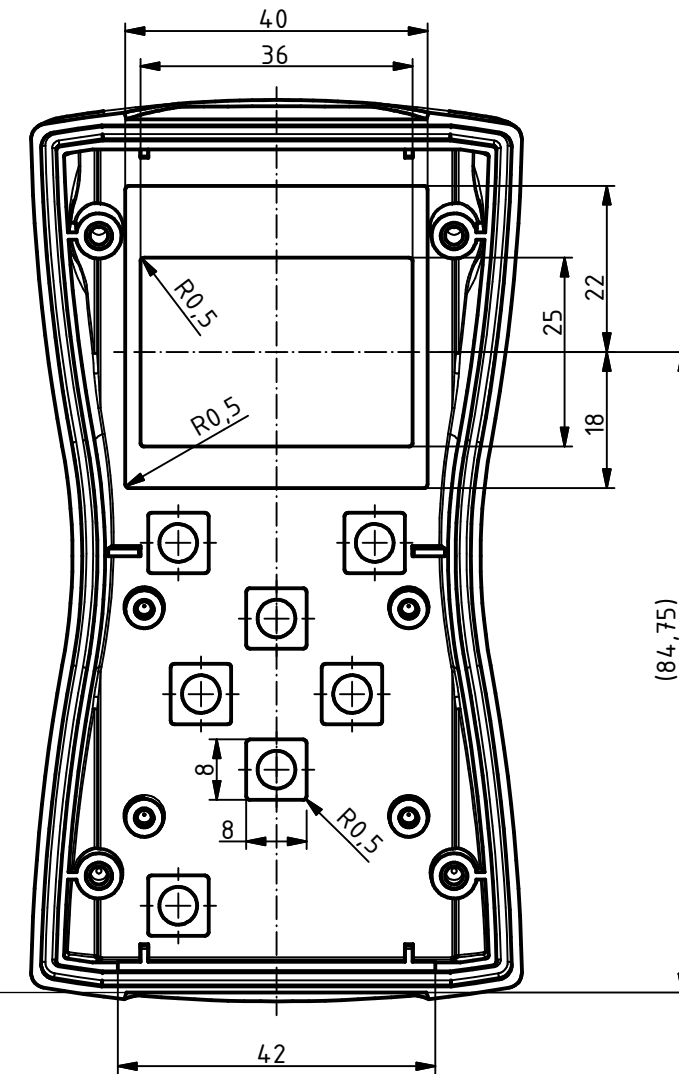
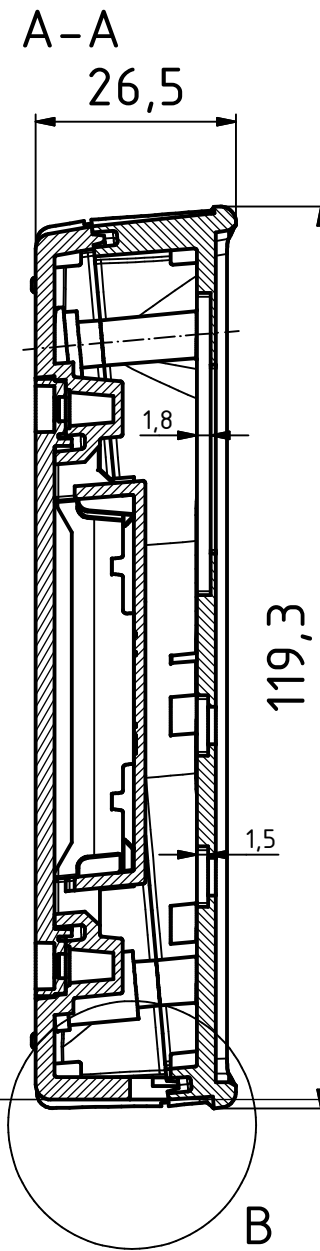
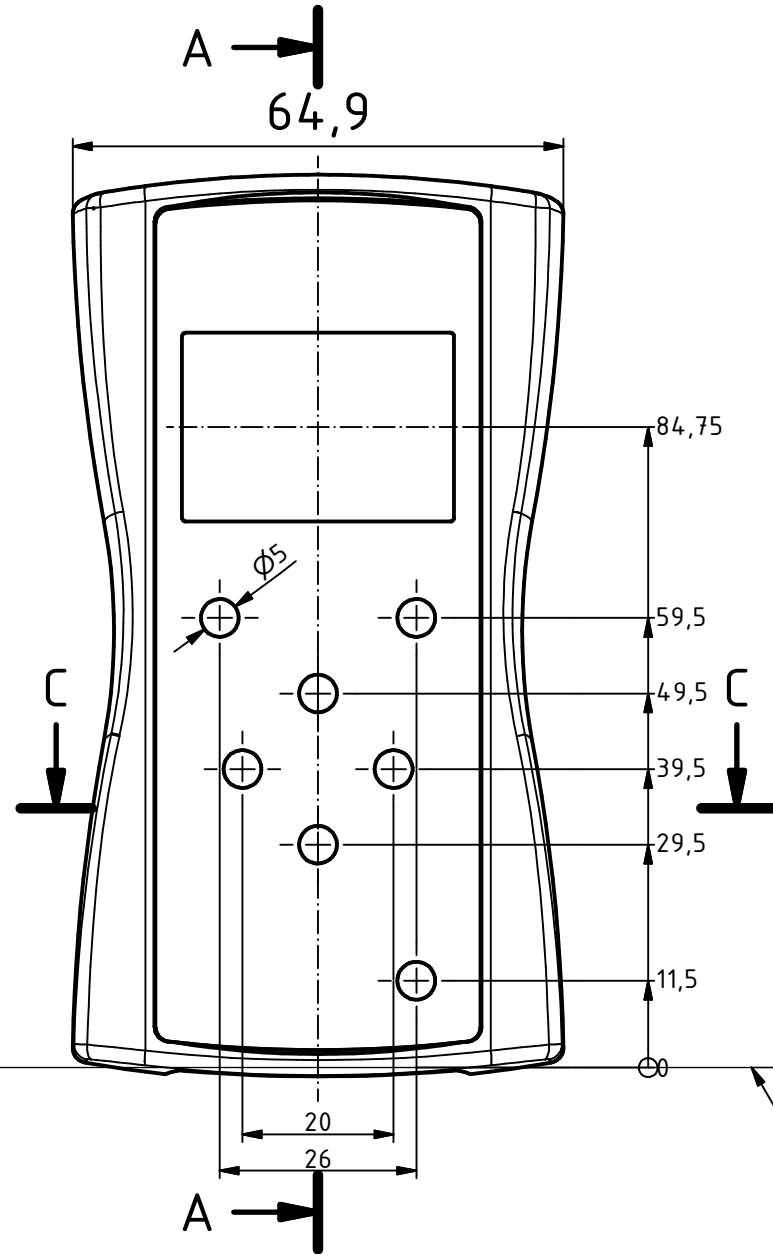
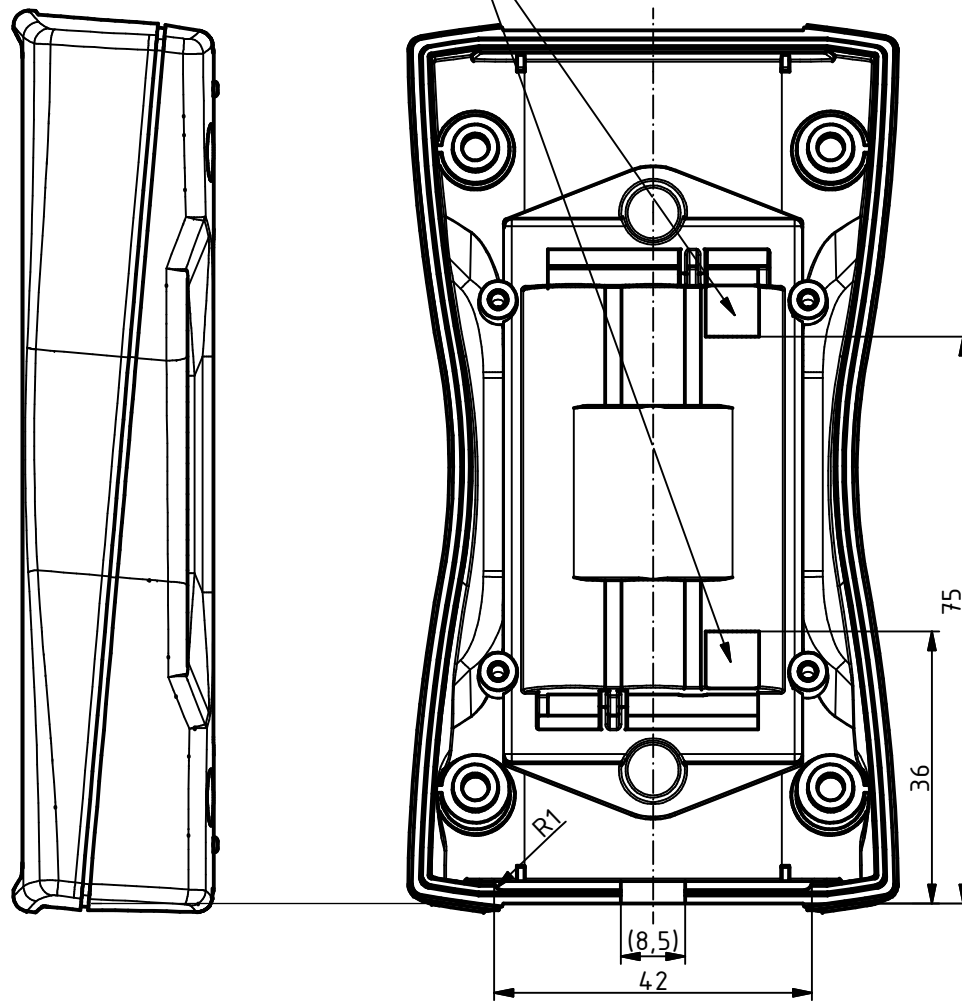

ISO (1 : 1)
(nur UT)

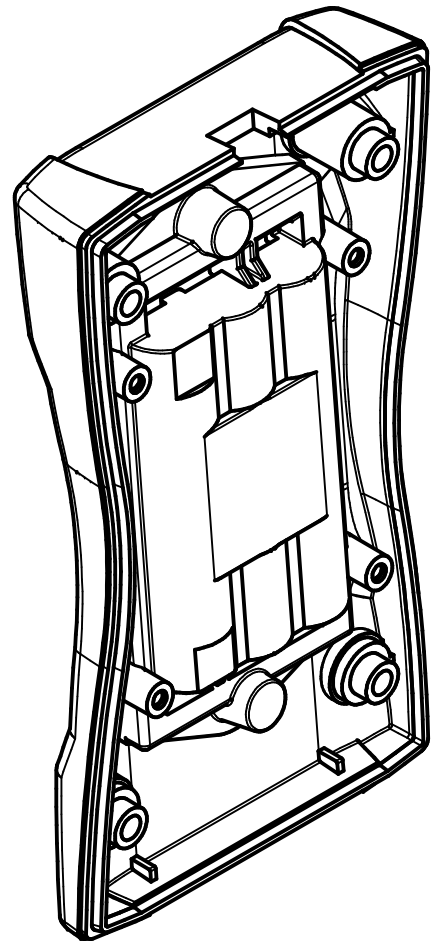

C-C (1 : 1)

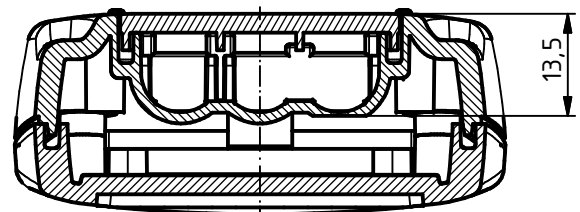

Bezugsebene Oberteil-Unterteil
Reference plane base-lid

B (2 : 1)

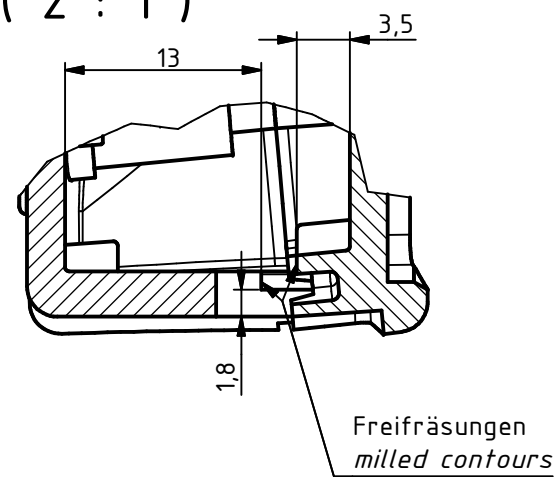

ISO (1 : 1)
(nur OT)

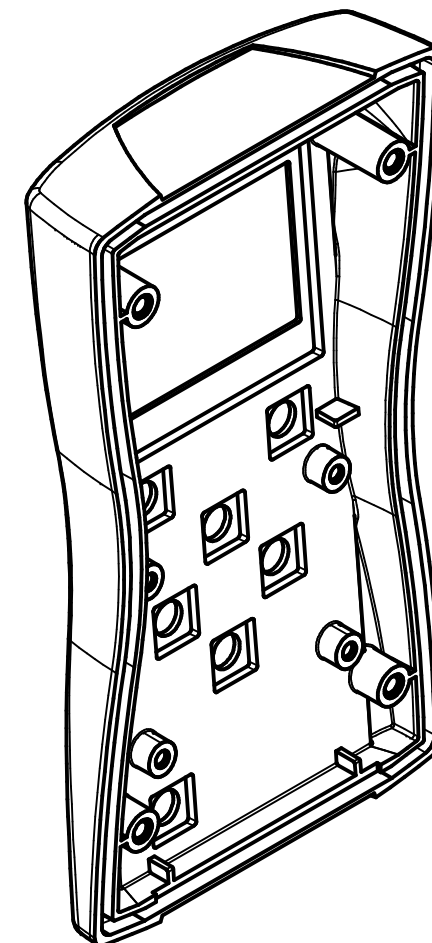

Bopla 4566 / ALG 12362		
Artikel-Nr. / Art.-No.:		
Werkstoff:		
Material:		
Allg.Tol.: DIN ISO 2768-mk für Bearbeitung DIN 16901 für Kunststoffteil Gen.Tol.: DIN ISO 2768-mk for machining DIN 16901 for plastic part		
Maßstab/ Scale: 1:1		
Zeichnungs-Nr. / Drawing-No.: 2B 5355.057.01.028		
Bem.: Erstellt nach Vorlage / Dim.: constructed by specification:		
Artikel / Article: BS 404 F		
 BOPLA A Phoenix Mecano Company		
A.Nr./ ALT.-NO.:	Datum/ DATE:	
DISK: 3022008.idw Datum/Date: 30.11.2015 KH Blatt/Sheet: 1 / 1		
Datum/Date		Unterschrift/Signature
geprüft/ checked		
Fertigungsfreigabe/ Production release		